

Ball Valve - ISO 5211 Direct Mount - 1/4" to 3/8"

Screwed BSP Female
Full Bore
ISO 5211 Direct Mount

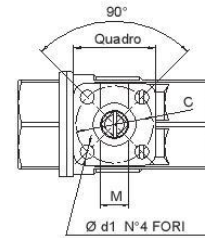
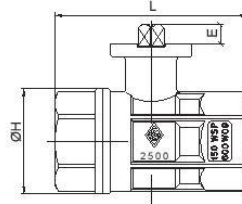
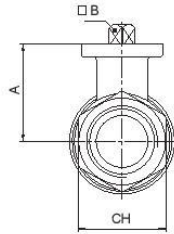

Dimensions

DN	QUADRO	A	B	C	d1	E	H	I	L	M	P	CH	Kg
1/4"	38	33	9	36	6	9	33.5	11	67	13	14.2	27	0.25
3/8"	38	33	9	36	6	9	33.5	11.4	67	13	14.2	27	0.24

Torque

Size	Torque (Nm)
1/4"	6
3/8"	6

Flow Rates

	1/4"	3/8"
KV	5.4	6

Material List

Body	Brass
Ball	Brass
Seats	PTFE
Stem	Brass
O-Ring	Viton

Pressure/Temperature Ratings

Max Pressure	PN40
Temperature	-20°C to 160°C